

*The Ruston Surveys*

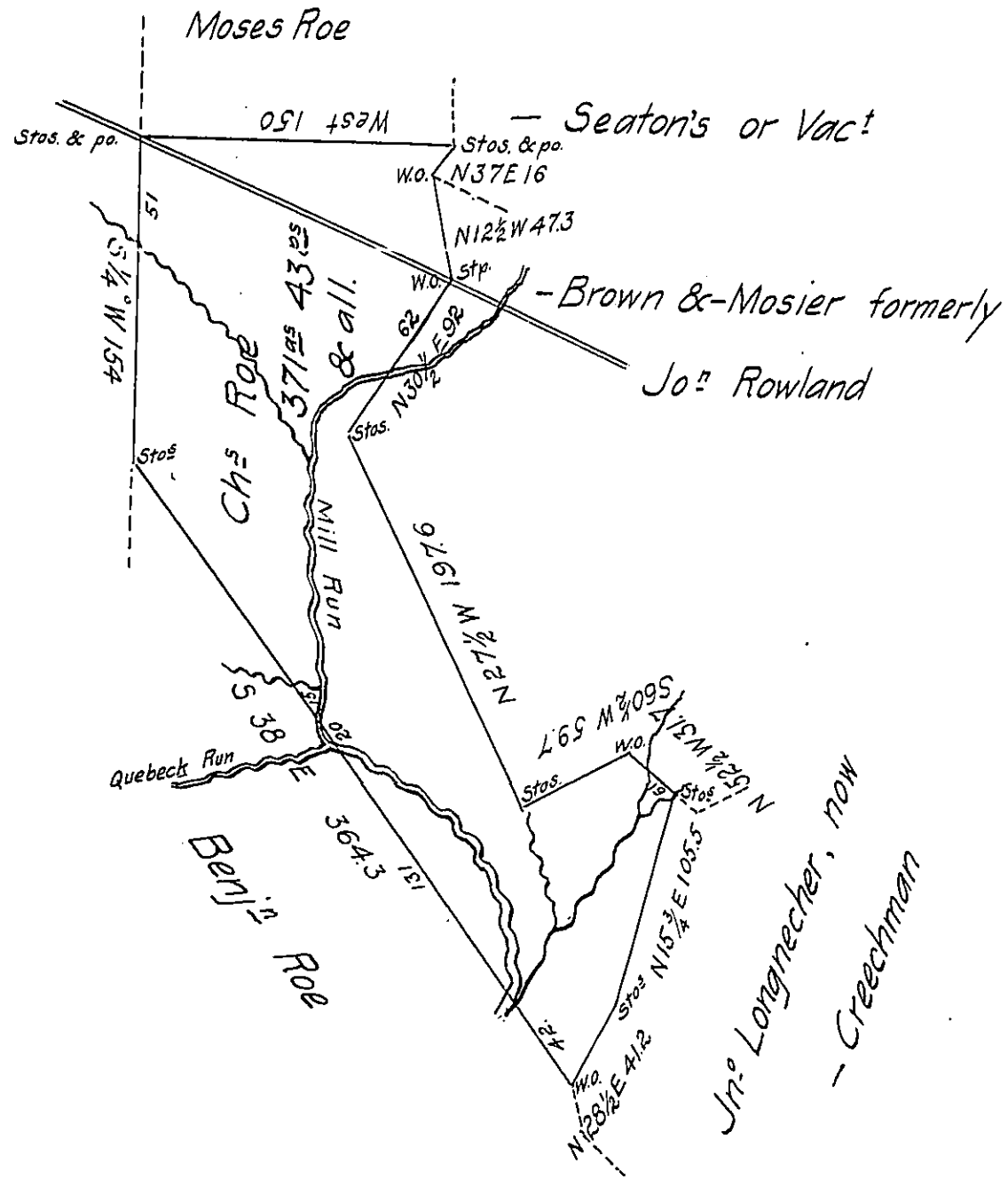

*Situate on Crosses Mill Run a Branch of Sandy Creek in Wharton township, Fayette County & Surveyed the 17<sup>th</sup> day of September 1835 In pursuance of a Warrant in the name of Charles Roe for 400<sup>ac</sup> dated the 5<sup>th</sup> day of February 1794. there is a dwelling house, a Grist mill, Stable & 6 or 7 acres cleared, and a family occupying this tract, the improvement is about 5 years old.*

*F. Lewis D.S.*

*To Jacob Spangler Esquire  
Surveyor General*

*IN TESTIMONY that the above is a copy of the original remaining on file in the Department of Internal Affairs of Pennsylvania, made conformably to an Act of Assembly approved the 16th day of February, 1833, I have hereunto set my Hand and caused the Seal of said Department to be affixed at Harrisburg, this eighth day of October 1906.*

*Isaac D. Brown*  
Secretary of Internal Affairs.